



INSTRUCTIONS FOR:

AIR PALM ORBITAL SANDER 150mm

MODEL Nos: **SA08 & SA09** (DUST FREE:SA09)

Thank you for purchasing a Sealey Product. Manufactured to a high standard this product will, if used according to these instructions and properly maintained, give you years of trouble free performance.



IMPORTANT: PLEASE READ THESE INSTRUCTIONS CAREFULLY. NOTE THE SAFE OPERATIONAL REQUIREMENTS, WARNINGS AND CAUTIONS. USE THIS PRODUCT CORRECTLY AND WITH CARE FOR THE PURPOSE FOR WHICH IT IS INTENDED. FAILURE TO DO SO MAY CAUSE DAMAGE OR PERSONAL INJURY AND WILL INVALIDATE THE WARRANTY. PLEASE KEEP INSTRUCTIONS SAFE FOR FUTURE USE.

1. SAFETY INSTRUCTIONS

- WARNING!** Ensure Health & Safety, local authority, and general workshop practice regulations are adhered to when using this equipment.
- WARNING!** Disconnect from air supply before changing accessories or servicing.
- ✓ Maintain the sander in good condition (use an authorised service agent).
- ✓ Replace or repair damaged parts. Use genuine parts only. Non-authorised parts may be dangerous and will invalidate the warranty.
- ✓ Use in a suitable clean and tidy working area, free from unrelated materials and ensure there is adequate lighting.
- ✓ Before each use check abrasive pads for condition. If worn or damaged replace immediately.
- ✓ Ensure the abrasive pad rating is equal to, or greater than the RPM rating of the sander.
- ✓ Ensure there are no flammable or combustible materials near the work area.
- WARNING!** Always wear approved eye or face and hand protection when operating the sander.
- ✓ Use face, dust, or respiratory protection in accordance with COSHH regulations.
- ✓ Depending on the task, sander noise level may exceed 85dB, in which case wear safety ear defenders.
- ✓ Remove ill fitting clothing. Remove ties, watches, rings, other loose jewellery, and contain and/or tie back long hair.
- ✓ Wear appropriate protective clothing and keep hands and body clear of working parts.
- ✓ Maintain correct balance and footing. Ensure the floor is not slippery and wear non-slip shoes.
- ✓ Keep children and unauthorised persons away from the working area.
- ✓ Check moving parts alignment on a regular basis.
- ✓ Ensure workpiece is secure before operating the sander. Never hold a workpiece by hand.
- ✓ Check the workpiece to ensure there are no protruding screws, bolts, nuts, nails, stones, etc.
- ✓ Avoid unintentional starting.
- WARNING!** Ensure correct air pressure is maintained and not exceeded. Recommended pressure 70-90psi
- ✓ Keep air hose away from heat, oil and sharp edges. Check air hose for wear before each use and ensure that all connections are secure.
- ✓ Prolonged exposure to vibration from this sander poses a health risk. It is the operator's responsibility to correctly assess the potential hazard and issue guidelines for safe periods of use and offer suitable protective equipment.
- x **DO NOT** use the sander for a task it is not designed to perform.
- x **DO NOT** operate sander if any parts are damaged or missing as this may cause failure and/or personal injury.
- x **DO NOT** use cloth backed sanding pads. Use only appropriate paper adhesive pads, following pad instructions.
- WARNING! DO NOT** sand any materials containing asbestos.
- x **DO NOT** carry the sander by the hose, or yank the hose from the air supply.
- x **DO NOT** force, or apply heavy pressure to the sander, let the sander do the work.
- x **DO NOT** place attachments close to your face and do not point at other persons or animals.
- x **DO NOT** operate sander when you are tired, under the influence of alcohol, drugs or intoxicating medication.
- x **DO NOT** use sander where there is flammable liquids, solids or gases such as paint solvents and including waste wiping or cleaning rags etc.
- x **DO NOT** carry the sander with your finger on the power lever.
- x **DO NOT** direct air from the air hose at yourself or others.
- ✓ When not in use disconnect from air supply and store in a safe, dry, childproof location.



LEAD PAINT WARNING!

Paint once contained lead as a traditional ingredient. Contact with the dust from the removal of such paint is toxic and must therefore be avoided. The following action must be taken before using the sander on a surface that you suspect may contain lead paint.

1. User must determine potential hazard relating to age of paint to be removed. (Modern paints do not have lead content).
2. **DANGER!** Keep all persons and pets away from the working area. The following persons are particularly vulnerable to the effects of lead paint dust: *Expectant women, babies and children.*
3. We recommend personal protection by using the following safety items:
 - a) Paint Spray Respirator (Sealey Part No. SSP1604)
 - b) PE Coated Hooded Coverall (Sealey Part No. SSP267).
 - c) Latex Gloves (Sealey Part No. SSP24).
4. Take adequate measures to contain the paint dust, flakes and scrapings.
5. Continue to wear safety equipment as in (3) above and thoroughly clean all areas when task is complete. Ensure paint waste is disposed of in sealed bags or containers.

2. INTRODUCTION & SPECIFICATION

Polycarbonate outer housing with soft rubber handgrip reduces hand chill and vibration. Fitted with dual bearings in eccentric assembly to maximise working life. Exhaust muffler helps reduce noise emission. Supplied with Ø150mm hook-and-loop pad.

Pad size Ø: 150mm
 Thread size: 5/16" UNF
 Free Speed: 10000rpm
 Orbit Size Ø: 5mm
 Operating Pressure: 90psi
 Air Consumption: 13cfm

Air Inlet: 1/4"BSP
 Vacuum outlet (SA09 only) Ø28mm
 Noise Power: 92.3dB(A)
 Noise Pressure: 81.3dB(A)
 Vibration: 5.7m/s²
 Uncertainty 0.54m/s²
 Weight: 1kg

3. PREPARING SANDER FOR USE

3.1. Air Supply

- 3.1.1. Ensure the sander's air valve (or throttle) is in the "off" position before connecting to the air supply.
- 3.1.2. You will require an air pressure between 70-90psi, and an air flow according to the specification above.
- 3.1.3. **WARNING!** Ensure the air supply is clean and does not exceed 90psi while operating the sander. Too high an air pressure and unclean air will shorten the product life due to excessive wear, and may be dangerous causing damage and/or personal injury.
- 3.1.4. Drain the air tank daily. Water in the air line will damage the sander **and will invalidate your warranty.**
- 3.1.5. Clean air inlet filter weekly. Recommended hook-up procedure is shown in fig.1.
- 3.1.6. Line pressure should be increased to compensate for unusually long air hoses (over 8 metres). The minimum hose diameter should be 1/4" I.D. and fittings must have the same inside dimensions.
- 3.1.7. Keep hose away from heat, oil and sharp edges. Check hoses for wear, and make certain that all connections are secure.

3.2. Couplings.

Vibration may cause failure if a quick change coupling is connected directly to the air sander. To overcome this, connect a leader hose to the sander. A quick change coupling may then be used to connect the leader hose to the air line recoil hose (See fig.1 & fig.2).

3.3. Dust Collection (SA09 only).

The dust outlet tube of the sander must be connected to a dust-free system in accordance with COSHH and any other regulations that may apply to the work area. For information on dust-free systems, contact your local Sealey dealer.

fig.1

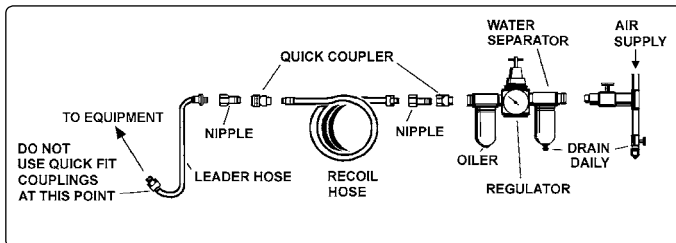
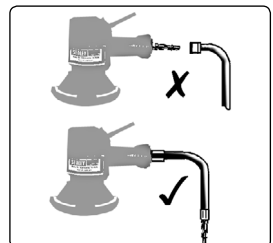
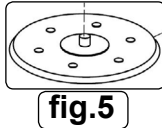

fig.2





4. OPERATION

☐ **WARNING!** Ensure you read, understand and apply safety instructions for use.

4.1. Assembly.

- 4.1.1. Screw in the backing pad into the spindle nut (fig.5). Tighten using the supplied spanner.
- 4.1.2. Apply the appropriate sanding pad to the backing pad. Use only pads with speed ratings equal to or higher than the speed rating of the sander. **DO NOT** use cloth backed sanding pads.
- 4.1.3. Connect the air supply to the sander and press the trigger, check that the sander is working correctly.

4.2. Operation.

- 4.2.1. Always use a sanding pad appropriate for the job.
- 4.2.2. Work progressively from coarse grades to finer grades.
 - x **DO NOT** go from coarse to fine in one step as it may be difficult to remove swirl marks left by the coarser grit.
 - x **DO NOT** apply excessive pressure, let the sander do the work for you.
- 4.2.3. Start the sander and bring the sanding disc to the work surface slowly and evenly. Move the sander back and forth in overlapping motions.
- 4.2.4. Remove the sanding disc from the work surface before stopping the sander. Regularly check the sanding pad for wear and always change a cracked or damaged pad.
 - x **DO NOT** allow the sander to run in "idle rotation" for an extended period of time as this will shorten the life of the bearings.

5. MAINTENANCE

☐ **WARNING!** Disconnect sander from air supply before changing accessories, servicing or performing maintenance. Replace or repair damaged parts. *Use genuine parts only. Non-authorized parts may be dangerous and will invalidate the warranty.*

- 5.1. Lubricate the air sander daily with a few drops of good grade air tool oil such as Sealey ATO500S or ATO1000S, dripped into the air inlet before use.
- 5.2. Clean the sander after use and change pads when required.
- 5.3. Loss of power or erratic action may be due to the following:
 - a) Excessive drain on the air line. Moisture or restriction in the air pipe. Incorrect size or type of hose connectors. To remedy check the air supply and follow instructions in section 3.
 - b) Grit or gum deposits in the sander may also reduce performance. If your model has an air strainer (located in the area of the air inlet), remove the strainer and clean it. Flush the sander out with gum solvent oil or an equal mixture of SAE No.10 oil and kerosene. Allow to dry before use.

If you continue to experience problems, contact your local Sealey service agent.

- 5.4. For a full service contact your local Sealey service agent.
- 5.5. When not in use, disconnect from air supply, clean sander and store in a safe, dry, childproof location.

Environmental Protection.



Recycle unwanted materials instead of disposing of them as waste. All tools, accessories and packaging should be sorted, taken to a recycle centre and disposed of in a manner which is compatible with the environment.

Parts support is available for this product.

To obtain a parts listing and/or diagram, please log on to www.sealey.co.uk, email sales@sealey.co.uk or phone 01284 757500.

NOTE: It is our policy to continually improve products and as such we reserve the right to alter data, specifications and component parts without prior notice. **IMPORTANT:** No liability is accepted for incorrect use of this product.

WARRANTY: Guarantee is 12 months from purchase date, proof of which will be required for any claim.

INFORMATION: For a copy of our latest catalogue and promotions call us on 01284 757525 and leave your full name and address, including postcode.



Sole UK Distributor, Sealey Group,
Kempton Way, Suffolk Business Park,
Bury St. Edmunds, Suffolk,
IP32 7AR

☎ 01284 757500

✉ 01284 703534



www.sealey.co.uk



sales@sealey.co.uk

WARNING! – Risk of Hand Arm Vibration Injury.

This tool may cause Hand Arm Vibration Syndrome if its use is not managed adequately.

This tool is subject to the vibration testing section of the Machinery Directive 2006/42/EC.

This tool is to be operated in accordance with these instructions.

This tool has been tested in accordance with: EN ISO 28927-3:2009 & BS EN ISO 15744:2008.

Declaration and verification of Vibration Emission figures are in accordance with EN 12096:1997

Measured vibration emission value (a): 5.7 m/s²

Uncertainty value(k): 0.54 m/s²

Please note that the application of the tool to a sole specialist task may produce a different average vibration emission. We recommend that a specific evaluation of the vibration emission is conducted prior to commencing with a specialist task.

A health and safety assessment by the user (or employer) will need to be carried out to determine the suitable duration of use for each tool.

NB: Stated Vibration Emission values are type-test values and are intended to be typical.

Whilst in use, the actual value will vary considerably from and depend on many factors.

Such factors include; the operator, the task and the inserted tool or consumable.

NB: ensure that the length of leader hoses is sufficient to allow unrestricted use, as this also helps to reduce vibration.

The state of maintenance of the tool itself is also an important factor, a poorly maintained tool will also increase the risk of Hand Arm Vibration Syndrome.

Health surveillance.

We recommend a programme of health surveillance to detect early symptoms of vibration injury so that management procedures can be modified accordingly.

Personal protective equipment.

We are not aware of any personal protective equipment (PPE) that provides protection against vibration injury that may result from the uncontrolled use of this tool. We recommend a sufficient supply of clothing (including gloves) to enable the operator to remain warm and dry and maintain good blood circulation in fingers etc. Please note that the most effective protection is prevention, please refer to the Correct Use and Maintenance section in these instructions. Guidance relating to the management of hand arm vibration can be found on the HSC website www.hse.gov.uk - Hand-Arm Vibration at Work.