

# SAFETY POSTER INSTRUCTIONS FOR THE SAFE HANDLING OF YOUR CUTTING TOOL

**martor**

## SECUNORM MIZAR

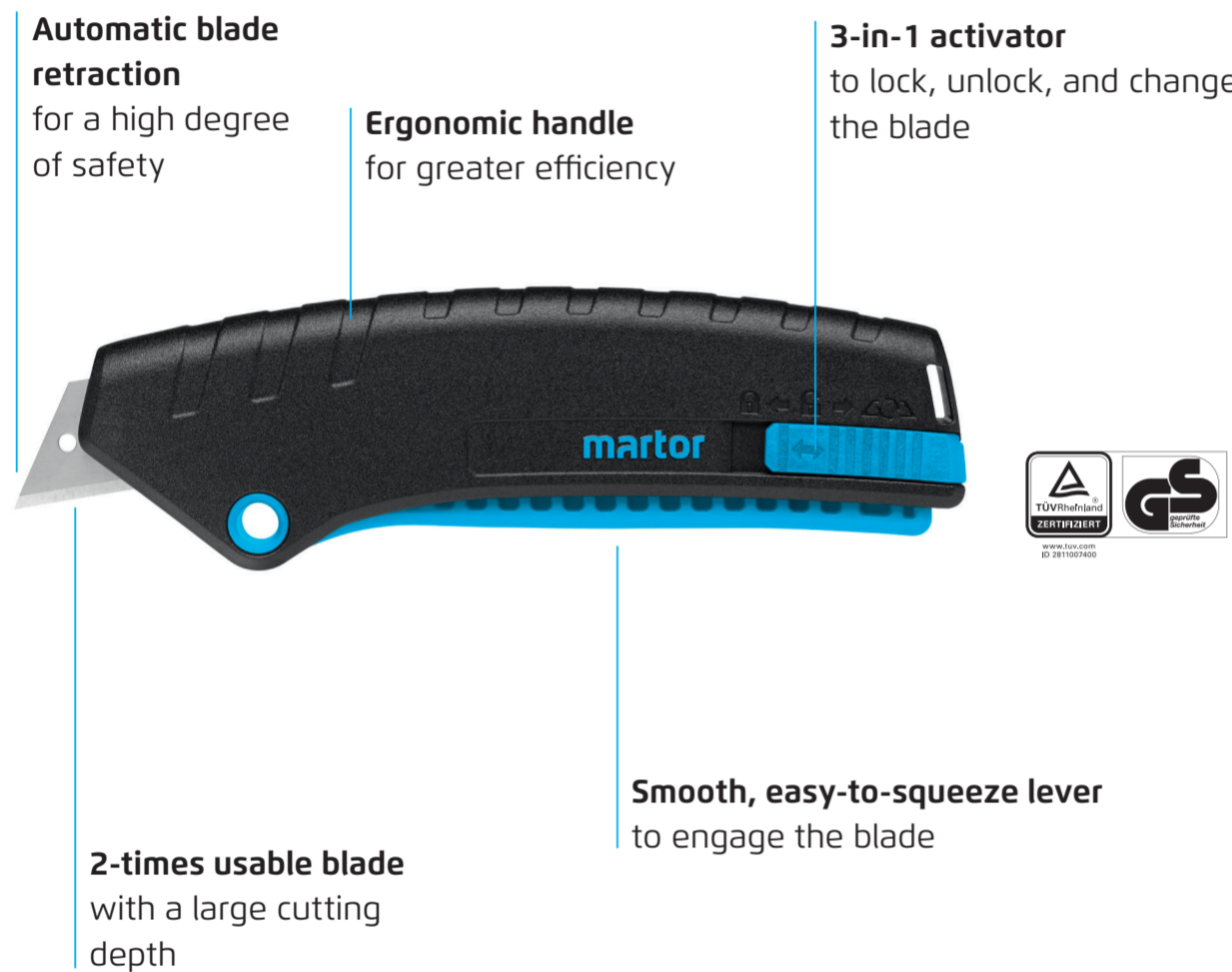

### USAGE

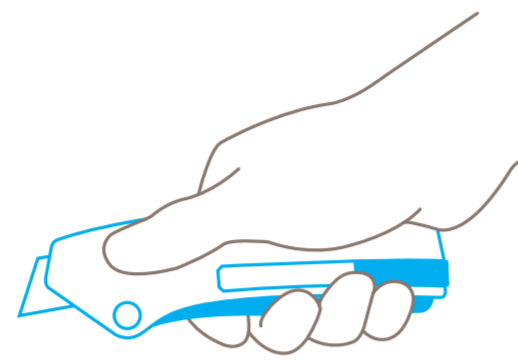

To **engage the blade**, unlock the cutter and squeeze the lever. Now you can cut.

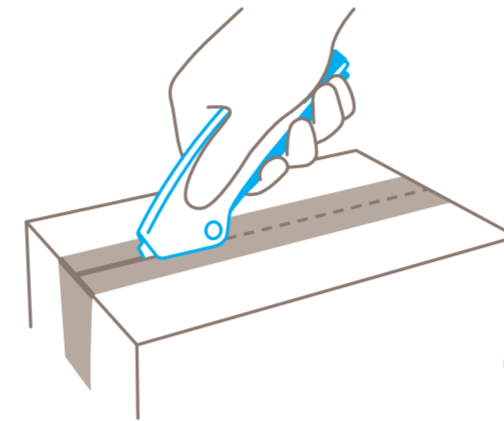

Use the underside of the cutter head as a supporting surface to **work ergonomically** and efficiently.

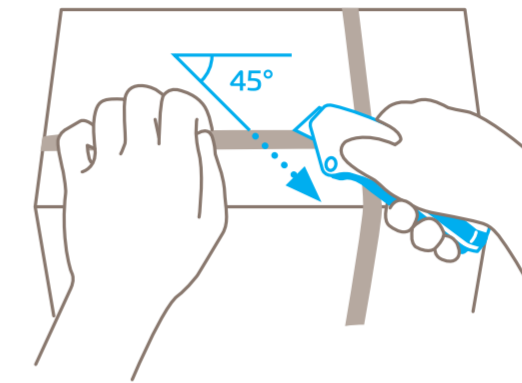

For best results, cut plastic strapping band **diagonally** (at a 45° angle).

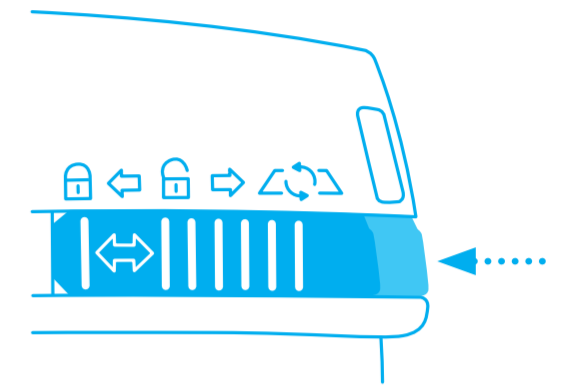

Use the 3-in-1 activator to **lock your cutting tool** after cutting.

### BLADE CHANGE

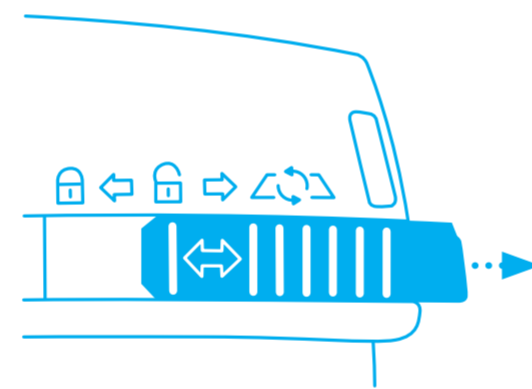

Move the 3-in-1 activator into its **rearmost position**.

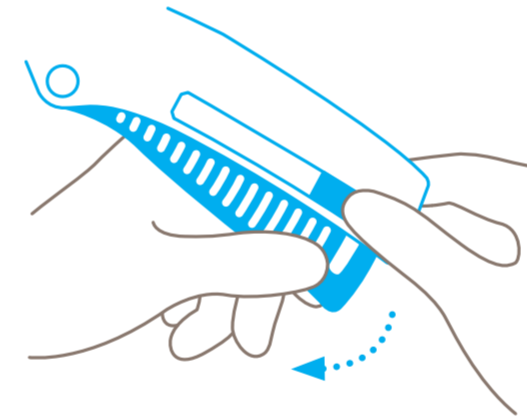

Swing the lever completely **out of the handle**, and flip open the blade cover.

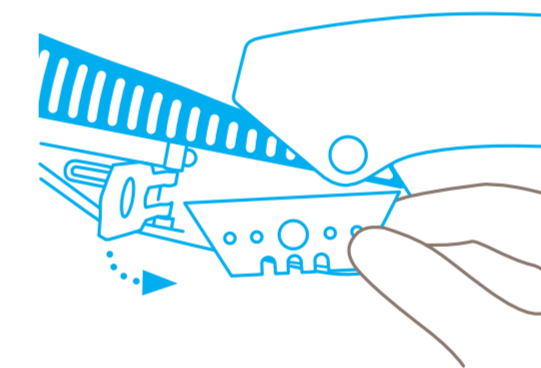

Now you can either **rotate or replace** the blade. Re-close the blade cover.

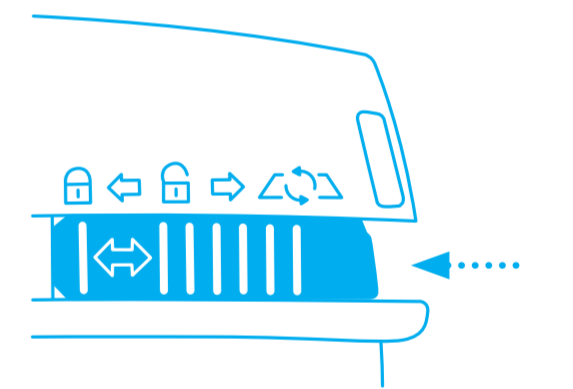

Swing the lever **back into the handle** and set the 3-in-1 activator to either lock or unlock.

### PROTECTION OF USER

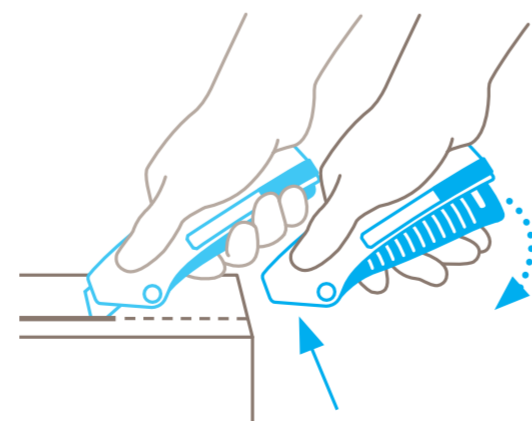

As soon as you **release the lever**, the blade disappears into the handle. And it stays there - until you engage it again.

### DISPOSAL

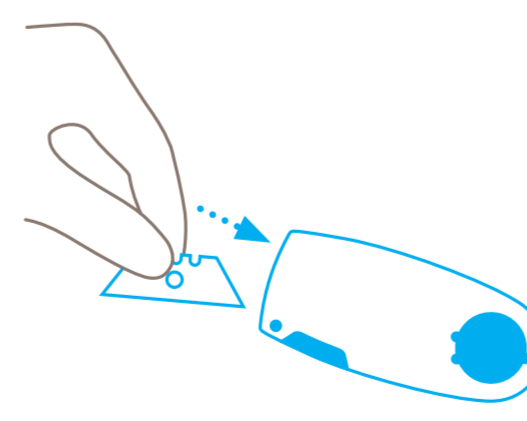

Your **SAFEBOX** is the best place to store **used blades**.

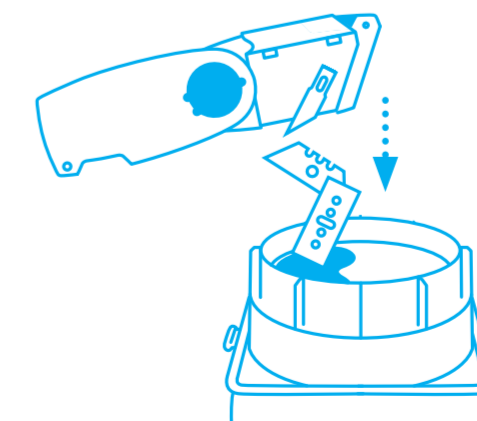

When the **SAFEBOX** is full, **empty all contents** into the **RECYCLING BOX**.

**Please note:** to ensure your product always functions flawlessly, regularly remove any build-up of cutting material.